From: Claire Williams <clwilliams@kctmo.org.uk>
Sent: 31 October 2013 10:24
To: 'Bruce Sounes'; d.campbell@maxfordham.com; M.Smith@maxfordham.com
Cc: Grenfell; BOOTH Philip; LIM Chwee chen
Subject: RE: Grenfell - overcladding VE?

Follow Up Flag: Follow up
Flag Status: Flagged

Bruce

Thank you for your 2 issues:

- 1 Upgrading of existing roof and tank room areas: Chwee chen, perhaps we can make this work all provisional – so we get prices but keep our options open. I do not know if the mast climbers need to be attached to the roof and this may cause damage, but in which case we get the areas 'condition surveyed' beforehand. But I agree; this is a good area of potential saving.
- 2 Fire strategy and building control: Bruce can you make this easy for me, and give me direct tel nos and any references etc. Also you need to do me a bullet point prompt on the specific areas so I mention all the issues. (3 days of holiday)

Thanks

Claire Williams
Project Manager



t: [REDACTED]
m: [REDACTED]

a: The Network Hub, 292a Kensal Road, London, W10 5BE

 Before printing, please think about the environment

From: Bruce Sounes [<mailto:bruce@studioe.co.uk>]
Sent: 29 October 2013 19:39
To: d.campbell@maxfordham.com; M.Smith@maxfordham.com; Claire Williams
Cc: Grenfell; BOOTH Philip; Chwee chen Lim
Subject: Grenfell - overcladding VE?

Duncan, Matt,

On a much smaller refurbishment project with Max Fordham recently we have successfully argued the case with Building Control for not upgrading areas of roof/wall that are not touched by the refurbishment. As I understand Part L we only need to upgrade the thermal performance of a part which is to be replaced. Eg a roof membrane/window etc.

The existing roof membranes look relatively new (and we think there is some insulation under them) and we have no need to upgrade/re-finish the plant room enclosure. The markup below indicates the area I'm referring to. This would simplify the work and contribute some big savings.

Please could you comment?

Claire,

I followed up the Fire Strategy submission we made to Building Control on Friday. I managed to get through to Paul Hanson yesterday. John Allen was on leave. He initially didn't want to offer any time frame for a response, saying he was very busy and there were other very urgent jobs needing his attention. I pressed him, reminded him of the issues and why we needed London Fire Brigade input and that they had offered to pass it on for a quick reply. At that he said he would get onto it next week.

We met John and Paul six weeks ago on 17 September.

I wondered if you had an leverage to ensure we get the critical feedback we need to inform the tender?

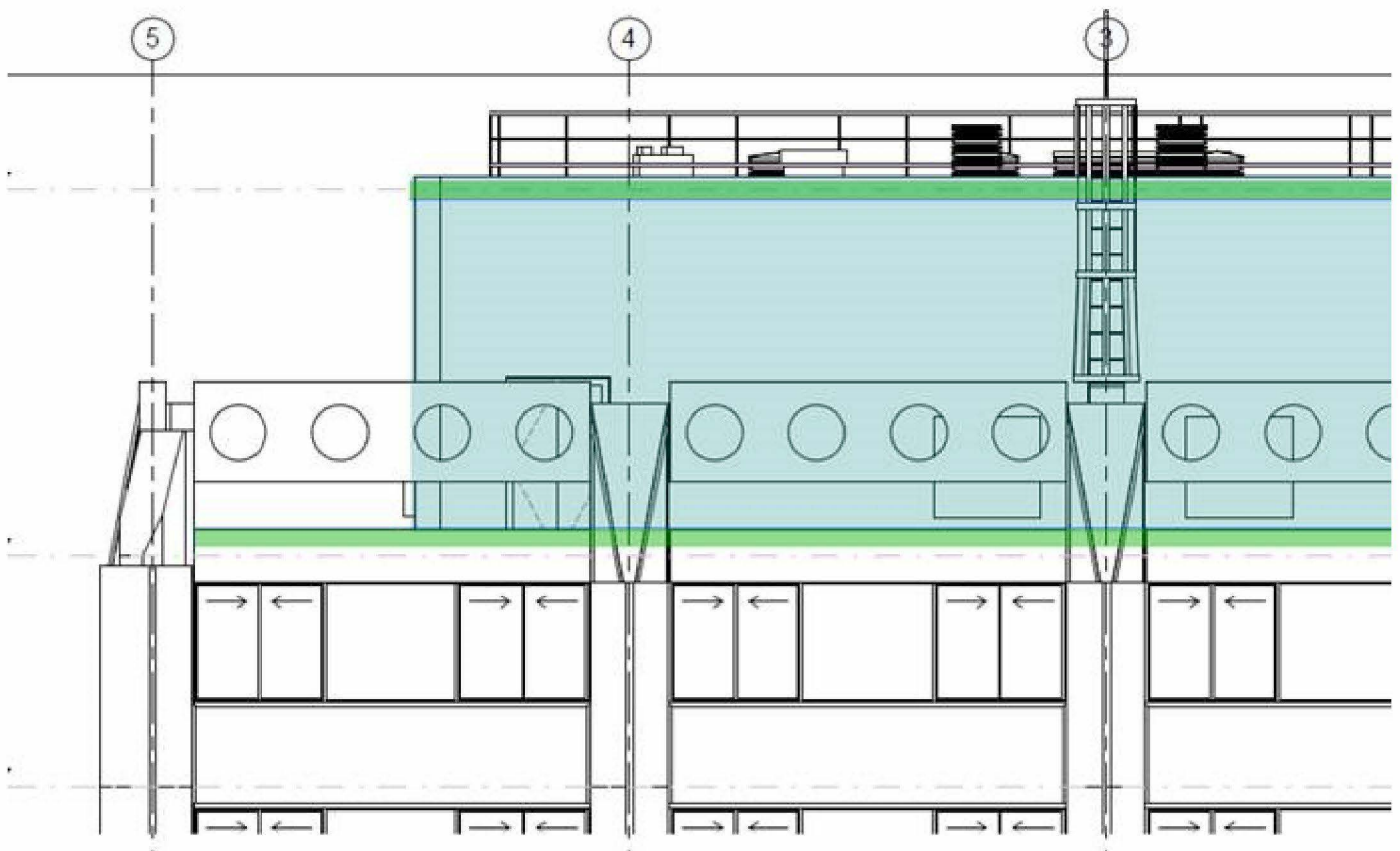

Regards

Bruce Sounes

For and on behalf of
STUDIO E LLP

Palace Wharf, Rainville Road, London W6 9HN
T [REDACTED] | F [REDACTED] | www.studioe.co.uk

This e-mail message has been scanned for Viruses and Content and cleared by **MailMarshal**

DISCLAIMER:

This E-mail and any files transmitted with are intended solely for the use of the individual or entity to whom they are addressed. If you have received this email in error please notify the System Administrator. This message may contain confidential information and is intended only for the individual named. If you are not the named addressee you should not disseminate, distribute or copy this email.

Please note that any views or opinions presented in this email are solely those of the author and do not necessarily represent those of Kensington & Chelsea TMO Ltd. Finally, the recipient should check this email and any attachments for the presence of viruses. Kensington & Chelsea TMO Ltd accepts no liability for any damage caused by any Virus transmitted by this email.