

Blt 2004 -

Records

- ✓ FA BGCP 1x week - residents warned
→ bell 3 seconds → then silence
(37 BGCPs)
Alarm connected to Day Care Centre -
sep [REDACTED]

- ✓ Fire Drills 4x p.a.
Staff only - certain staff are allowed to
stay - lived + recorded
Night drill - LD - checks
3 fire exits. ✓ PHE

Alarm goes off 1 person → fire panel
each nurses station → 1 person goes to main
fire panel 1 meets LFB
~~PHE~~

- ? E.L. - non-maintained -
tested monthly by maintenance

FFE (over 100) 15/1/2016

- ✓ Gas Safe Cert 20/9/16
- ✓ Fixed elects 10/12/2015
- ✓ PAT 22/9/2016
- ✓ Ducting last cleaned 4/11/2016

Staffed 24/7 FA not linked

- ✓ Furniture FR blinds + curtains
- ✓ lifts 6/2016 (Annual)
- ✓ Extractor fans - monthly

All bed-linen provided by company
resident - own ornaments & clothes

Residents

2 dementia floor (3rd & 2nd)

1st mixture

Ground - respite & end of life

No smoking - hut 1.8m from bldg -

3rd

each res rooms, dining, kitchen, nurses
station - rooms have ensuite & common
bathrooms -

* Each fire exit 4 + Alpac Mats FANS

FA = LI system

~~Staircase needs to be~~

FFE instructions missing

4th Floor -

Fire evae shared - 9-5

Don't join in drills

1st Hairdressers - has she had live sat
ing

Ext escape route
- not clear - smoking

Front exit gate padlocked - remove

store rooms should be locked
shut -

Laundry room - staff
clean link daily

DB1 door on FID nr

no CO₂ in lift motor room

Generator

CO₂ lift mtr

FE sign rear gate

locks removed + alternative

locking store room

Syn 14/11/2016

Monday 14/11/2016

The Pavilion

Wood Lane

W12 0HP

9:15 → 12:00

Alias = North Pole Rd

Owners

Greene King

Bury St Edmunds

Manager on site

Radmila Nikolic

address = pub

email = 7891@greeneking.co.uk

Staff 12 staff

cleaners → ser co. Name Clean - must

have had fire safety trng - GK requires

Busiest 5 staff

Covers = 148 = 148

Function RM 48

Total Capacity 350

Staff trng

2/11/2016 - Fire drill - trng by (RN)

RN has attended Greene King trng courses

- presented by qualified trainer RN has certificate

Also on-line trng -

Trng repeated every 6 mths.

" on induction

DD A included by GK but not by RN.

Ext escape route
- not clear - smoking

Front exit gate padlocked - remove

Store rooms shd be locked
shut -

Laundry room - staff
clean link daily

Db1 door on FD nr

no CO₂ in lift motor room

Generator

CO₂ lift mtr

FE sign rear gate

locks removed + alternative
locking store rooms

Syn 14/11/2016

Records

Fire drills 2 x p.a.

Yr = Mar - Mar.

3/5/16 2 Min

2/11/16 2.30 mins

EL

internal - 1 x per month

external - 2 x p.a.

FA

internal 1 x per week

external 2 x p.a.

18/4/2016

FPE

1 x p.a.

- Same overdue but couldn't be serviced due to closure for refurbishment

All staff trained to use FPE

Whole bldg FA linked - includes Managers' flat (2 HOE)

Ansul

20/4/16

Fixed Elecs

Gas

PAT

Ducting

25/1/2013

all kept H.O.

12/9/16

3/2016
b + micro

10/8/2016

Ducting cleared probably 3 x p.a.

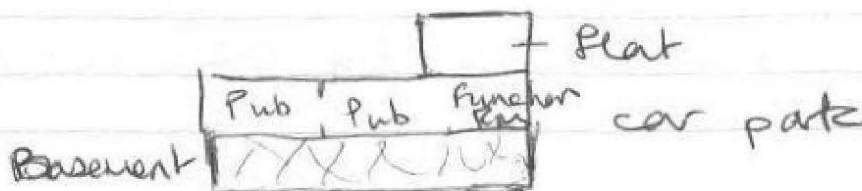

Pub at least 1870 ish

External contractors

H.O. arranges - all contracts (competent)
always accompanied -

At audit

2 main doors locked + function room
recommend hootz just inside

Kitchen - not refurbished

Insul + HD

Filters cleaned weekly

old oil kept in garden - picked

2x per month

New oil in basement

Ducting clipped to TR19

Basement

Jump Room

EL & SD - chimney breast - void?

① Fridge - food storage - no EL
Fridge not closing fully
→

② Function room cellar (bar)
Fridge door 120 CF into Fran

③ Small store SD but no EL
door as above

Fire exit door catches on
wiring on ceiling

2nd Fire exit door - not closed
fully into frame

Colleen under bar - holes in ceiling

~~1st Floor Office behind bar door~~
~~1st Floor~~

= Cables hanging down in basement corridor

Notice to:

Risk Mgt team

Attn: Jim Archer (Risk Manager)

Greene King PLC

Westgate Brewery

B S E

Suffolk

IP33 1QT

Early 20th C bldg -

Tuesday 15/11/2016

adults 18-65

17 Rivercourt Rd - Short break service
(respite) ^{generally autism}
^{dementia physical}
^{learning dis}

5 customers 1 room sleepover + 1 waking night
FFE all staff will be trained (if not already)
FFE checked every week - recorded

10:00 → 13:00

Options 280 Goldhawk Rd

staff 12 - max 4/5

GBEPs

PEEPs part of H+S risk assessment

Basement

2 water ^{regl}, gas valve, lift motor room
elects intake

Ext person - shown to site

Fire evacs drills - staff + residents
3 monthly

1 x lift - cannot be used although hydraulic

Records

EL 1 x per week - recorded

Evac 4 x p.a. listed + recorded.

FA 1 x weekly

PAT 2/12/2015.

Fixed elects due ~~up to~~ 2019

Gas safe May 2016

Cleaners = staff

Ins ✓

T/D Flushing sheet - needs to be signed

FRA - OHS 30/9/2016

Attached

Hard of hearing - looking at ^{interactive aids} ~~at~~ ~~tools~~

red light ~~disorder~~ in ^{SD} ~~EL~~ can affect customers with autism

visual - have 1 to 1s

Basement

Car motor room - plus water
heaters locked shut

Lobby - etec intake

Lift motor room - no CO₂

Water Room - storage SD

Communal bathroom

No EL - glare above
door - may see light in lobby

Hallway - BD 2 close to light

1800x
3
5400

2955/98 800
102.92 9.82
1853.06 787

Thursday 17/11/2016

~~Thursdays~~
Maurice de Gaborie - Garbutt

Chanh

10:00 → 12:45

Sycamore House

2:00 → 4:15

Gdng

W6 078

Met with Arvydas Kacinkevicius
Achy Mr S advisor Kammersmith United
Charities -
Sycamore Hs Reg OFF
Rita Nath-dongre Head of Reg & Prop Services
Wnt to Chief Exec
Tim Hughes (CEO)

8- 1:00 Sat/Sun

Staff max 8 - m 3rk 8 - 4:00

Residents 54 - ~~No covers~~ 10 covers

single 1 bed flats - interlinked SD + HD

+ warden call

Monitoring centre out of hrs

2 sep lines 1 for warden 1 for fire

Staff mg - last mg 2010

~~Atten Fire~~ - need to be kind as

fire Marshalls - inadequate staff mg

but in hand

Evac - 8 Nov 2016 - staff

Nov residents as stay put - not lived
at present

(Ord, 1st & 2nd)

In that person or as it don't duty manager,
would check → 999

Old bit blt 1962 - 60 mins

New blt. 2012

Internal Checks

PFE on each end - staff not had to use
vehicle in my - visual check

PA tested weekly by ALK (Thurs)
Records seen

EL 1 x p.m. - visual Fish tail 20/10/16

AOVs check tested 1 x per month 11/16

External

FA. 15/9/2016 Albion Fire Service 50%

EL 25/9/2015 overdue

PFE 2/16

AOVs ?

FDs ALK surveyed 3/11/2016

FIR ^{franchise} - apparently FR

Fixed Elec 2014 + 2016

Gas - 2 boiler room gas safe cert

Flats rented

PAT - 2013 - AK will do by end
December

FRA 17/12/2015

Action Plan

No PEEPs -

FA currently LS? recommended to
upgrade to 22

Check it Hampshire visit -

Control exit door - not open

Laundry room separate

Same Comm Area 19

for Intake cupbd - not FR & holes
several need filling

near

opening windows

23-26

the consumer unit cup

under flats large holes

B&L contractors - induction - Scheme Manager -

Fire exit sign needed outside

Fire exit ~~keep~~ clear

Scooters -

contact Gareth re scenario

ARVYDASK@HARRISONHOUSING.ORG.UK

6 months.

syn 1/12/2016 NOD

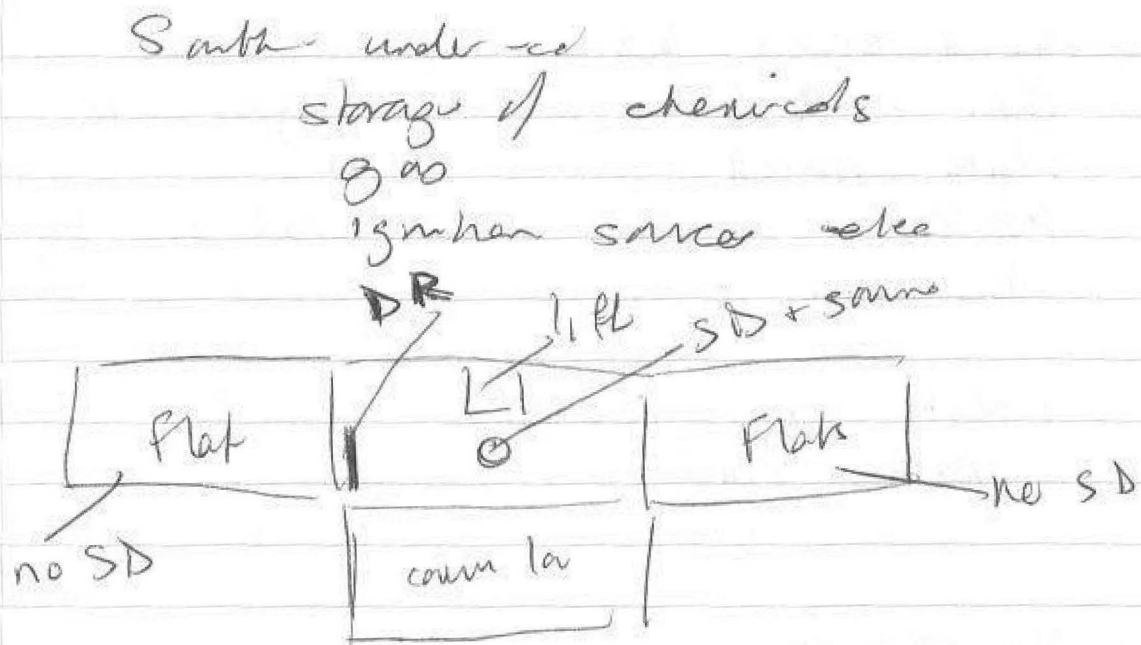

1st office ✓ the PFE

~~Star~~ Star lift - serviced annually

AUVS on stairs - can be
overridden by fire panel

Comm DBL doors - nse aykd
not fire stopped - south

3 sep bldgs

520

1623732

140
17/11/2016

140

12:45 → 2:00 - Sheltered Independent living
1960s with suppt

- 32 Flats more 32

1 staff + suppt wte 1 x p
week - 8 covers

Edward Morrison

Independent living

Cave line monitored - Fire alarm Red Care
Records Allied Protection reset fire panel. → 999

FA weekly

EL 2 x p.a. - central

Pull

Walk about 1 x p week - includes FD.

FFE checked 2015 - need to confirm
getters

FA Maintained Allied Protection 22/9/2016
SD 18/7/2016

FA - sounds throughout bldg but EP
is stay put

PIB - info on residents

Plan of bldgs

FD everywhere LI system

Flak SD + HD

Flat doors FD30BS + S/C - new

doors 2015

FANS

Laundry room HDB - Hlks checked
reg - domestic 2 hoovers regu

FRA 2015

FATIS

Only 1 resident's

← Tenant have nominated family member

• LFB visit regularly

All tenants

PAT in common areas. - 27 p.a.

Fixed electrics - ~~not done~~ all flats re-wired
2008 + 2009

Furniture FR

Fire exit signage - none outside

EL throughout

Fault on fire panel - will repair

EL not working - flats 17 + 18

PFE in Elec intake rooms not
serviced since 2012

Alt ~~en~~ at rear 3 Sh

Ext F E signage

Records Post audit

Boiler serviced	6/3/2015
Gas safety	3/3/2016
PAT	10/6/2015
Asbestos test	2/11/2016

syn 1/12/2016 BC

Plats 1 - 33 (no 13)
Flat 1 - resident has
switched off self closes

Suggest Dermaid

Blt = 2006 ish
*Flat 2 = ND + SD
? cabinetry

Plats - bedroom, bat +
kitchen/living + wide
entrance hall
water heater - SD
SD in hall

meter room each floor
SD, EL, CO₂ 10/16

05
Tues 22/11/2016
Mary Seacole House, W6 OHp
Bldg = grd, 1st, 2nd + 3rd
FA Weds 1 x p.a
EL ✓ 1 x p.m.

Bldg owned Cave UK
Landlord Hanover Hk & Ass.
Mears Cave provide Care

Mears 24/7
waking night -

Hanover On Call - 24/7
linked system
- 2 Mins -

Canned dining room
lunch provided - not all
used - not cooked on site

Fire curtain down

Scrub room - 2 exits
- covers ship's hallway -
water heater

Kitchen - old oil → contained
→ outside

No Gas on site
Angelo can use PPE

Interserve - 3 hr EL
best

Asstl bathrooms
EL

Elce intake
EL, SD, CO₂

Shop - SD, FR glazing,
Beko Indge PAT.

Laundry room - 2.4/7
Fire exit - FDKC sign

Fluff - core staff +
students told to clear litter

FD 30 → not smug
Clay stairs

FDs bi-monthly checks -

star lift tested 2x
per week because battery
gas flat
- only battery -

No evac chairs

lifts serviced 1x per year

Staff not allowed to
change light bulbs
- insurance

Cpd under star
wat He - storage
but SD FD plastic board

EL maintained

Top Floor 3rd
2 - 2 bed flats
+ guest room
needs FAN on door

Hardcore room
1 x pr - 11 night

Head office

Bob Stevens

Head of H. S

Kanover Hs As

Nelson Hs

Att Alington Rd

At Eynesbury

St Neots

PE19 6RE

syn

7/12/16

53

piotr@
mamounialounge
2780x
eqn 41
1120
3

Weds 23/11/2016

Mamounia Lounge

136 Brompton Rd, SW3 1HY

Meet with Omar Wafai (Director), Peter H² (CH)
H² 20

Travel time 40 x 2

Arrive 10:00 → 11:45

Bldg = B? / end + 2

Basement - Handi restaurant - not related

Ground floor - res, kitchen dry store

1st floor rest, office + storage + staff

2nd floor

Bldg owned by Hargrave + Cheval
Mamounia Lounge Knightbridge Hotel

Bldg has alarm panel - M + C

M 2 panel fits in

→ ADT → test - test informed - 3 BGCP

ADT monitor when closed phone O or P.

- can check if fire via CCTV.

False alarms recorded

Whole bldg panel monitored by CTA -

Staff - 35/38

Buarest 14

Cleaners - 8-10 - employed by M.L.

incl. hrng

Trng - provided by D + M Fire Protection Ltd
Induction + repeat trng

Evac 2 x p.a - staff sign

covers fire safety awareness

Duty Managers FM hnd x 3
Head Chef - hnd. - Sous chef

Records

FA - weekly

EL - monthly

Add FD checks -

Ext Ma held by CTA.
2x p.a.

* EL - maintenance not known -

enrol link to DCLG guide.

PFE 2016 ✓

Bhesha pipes - only on terrace
coal stored - coals heated in kitchen
kept in FR container → taken to
terrace - coals dished out
coals stay in one piece - movement
Minimised - canops FR -

Ext Contractors.

Peter = Piotr

Ducting - small dryer
cleaned 2 x p.a.
Gert ✓ 3/2/2016

D.J. - regular -
Add CO₂ exchanger

PAT - regularly ✓

Filters 3/4 hrs a week ✓

= Cold store - no SD - P to
email ~~xxx~~

FIS Kitchen door no S/S

FRA 10/5/2016/
Dr M Fire Protection Hld.

P to email.

send to Piotr

EL maintenance

Discussed: adding fire doors to check,
additional SD in cold store and
reducing height bar storage, add CO₂
behind DJ, magnetic device on 1st

Gas cooker -

CR didn't know about F.A.



Music He
Gas meter not in PR

integrated SD in little rooms

No time for FFL

Peripatetic teachers

Down through - used early morning

Music

RE through Bush Hall

MOE - not clear but not unusual

Bush Hall

Covers - 350 standing or
sentinel

Green room - exit door bolted
- need another method

FL Sign -

Not listed but Bld of Merit

No SD in in hall

Perform - run in + PRA

staff - 15

FD -

total - staff 8

Dbt doors - no 2 M.

- FD are manual

Fire bells x 2 also PA system

Stag - open

Staff know who's in - security & duty
manager checks

will sweep before leaving

small cellar. stairs need FR
protection

Offices > 3 CI photo

9-6

Office door not FD

Residential above -

SD outside

1x SD inside - recommend
change lock to HD

All doors are locked at night

Alternative - flat roof - staff &
owner might use

~~the fire alarm system~~

Brush Hall Dining Room 304 11:15 -
Covers 72 - Charlie + Jo Bennett

FA ✓

EL ✓

Furniture FR

Signage extra needed.

Dining docs not seen

FRA not S/S. - no disabled

FD between kitchen S/S missing

Staffing inadequate - done by Charlie -
cork 2003

Final exit door opens wrong

Wooden ceiling + walls - FR treated
stated by CR.

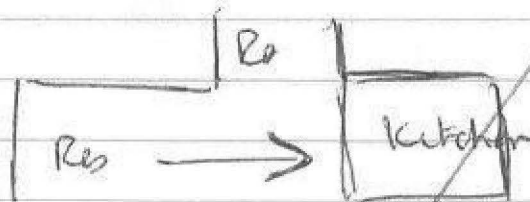

Door between is for deliveries

Glens

PAT

Fixed elcs - 2013

cords not seen

Music - not D.J.

Staff 4 chefs

4 FOH

But ent - accompanied

Keyholders = 5

~~4~~ 2 Flats above 308
2 Flat above 304
all alarmed - our front door

Door states 304 - 306

Charlie = 308 = flat - other

310 = Veriue

Fire exit Drunger Rd

① Communal Facilities

② Block 1-28 1623636

1700301 ③ Block 30-41 Travelling ?

9/12/2016 - 10:40 →

45 + 24
x 15

120 +
30
150

Wentworth Court

Laundry Rd

W6 8QP

Office

HD SD + EL

Office door wedged - FD

Elec PBT 12/15

Foam FFE outside - Not in office last 1/13

Laundry Rm

LARGE Wedge to FD

CO2 - 1/13

HD

EL not wkg

Final exit handle → snib

No FB keys - postman can't
get in

Resident's lounge - separate

SD x 2

No Smoking

2 dbl fire exit doors lead to
outside - only left hand wks (1st)

Other FE back into main bldg.

Other door leads to room used

Mr F ~~Chapman~~ H F V C - no FRA
at 21 co-op + card.

Side room - Helium canister, Armchair
FR.

Side room

fire exit door blocked by sign
other exit back into main bldg - handle
+ lock

2 residents bed bound - don't smoke
~~no~~ no PLEPS care packages

Hsg is independent living - sheltered hsg
Manager not privy to info

~~FA~~ - Info in PIB

FA tested 17 p.a. - report
EL - not respons.

Service contractors just turn up so cant
service

Flats S.D. - checked contractually

FRA 2013

Trng - very generic - not by ext.
comp. - colleague hnd.

Sue 9:00-12:30 M-F

No one at weekends

Alarm straight to caroline always

EP. Stay put

FFE

42 residents can use space

Used by Age UK etc - outside
~~FFE~~ people.

Activity co-ordinator responsible

Private parties - residents use -

Alarm goes to ~~call centre~~ Caveline
- Sue doesn't know.

Residents pull cords tested 3 months
Allied Protection -

Kitchen

Sue does periodic checks with residents

Ex Contractors = arranged by - always
Mike - Not Wk go to head office
- might sub contract -

Boilers in flats

Fixed elec - Sue doesn't have.
Gas checks annually

Mike do inspection

Barter room

All council accommodation

age 60+ (less than £60,000 p.a.)
no guest flat

Kitchen

used ashtray
etc PAT

Hob - elec

Nicola Mulburn (Mrs other)

Back door - used as FE not signed

Rm off - lounge
SD

Gas meters - ~~park~~ not in FR
Elec intake - shift stored

No PEEPs for residents
No progression assessment

Residents smoke =

TD not cleaned of fluff

cleaner M, W, F - shld do at
least once at week email Sue

Door

1 2 3 4

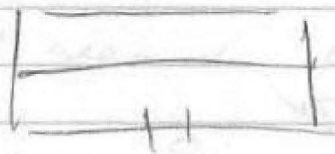

single stair

SD, EL, FENG

Make up open - shld be
wke FDKL
s/c on outside of doors

Wheelchair exit button to
close to final exit

EL not wkg
Door opens inwards

Block 5, 6, 7+8

M'b scooter - charged in common
pals

9, 10, 11, 12
is s/c to 10 on inside
Flat 9

13 - 16

exit button too close to
door

EP seen - out of date - info irrelevant

~~Sue~~ Sue checks flats 3 times
p.a. - Apr / July

No PRA on site =

3. Stevenson Jones - FR ??

17 assisted evac - work with social services

No copy of Care Plan given to LBHF

LBHF need to get into from care
agency -

EP is only lip service

Sue refers to Social Services

Susan - Crosby - dyas @ LBHF.gov.uk.

Weds 4/11/2017
~~106~~
~~160~~ Goldhawk Rd

Olivia Dolce
W12 8HD

3 staff - no FRA

Mr ~~Elk~~ Faisal Mahtooz - long staff

Basement

core

Store room

No EL

No Early warning

Bed - 3 people - laptop

Toilets

FFE 19/6/2012 out of date

Very ancient SD/HD?

Mr Amir Khan - Manager

724 Uxbridge Rd

UB4 0RX

email [REDACTED]
[REDACTED]

2nd store - shower in it

Elec's dodgy

Landlord's office locked

BGCF at base of stairs - not
wrg

Elec's cup on stairs - door not

FD 30 + NLS

fire exit door 1st floor
leads to final exit not signed

Office at top stairs
EL - wkg?

Good

Back treoper

Pizza oven - gas

no records of servicing

Back extension

Chinese food cooked - extension

Also EL

Flat roof

needs maintenance

Ducting cleaned monthly
- external -

Syn 30/1/2017

4/1/2017

Union Canal Deli 2:15 → 3:30

Meet with Steph Pena-Nur Manager

Fire Plan (seen) for whole bldg.

UCD is part of Workspace Group
Grand Union Studios

332 Ludbrooke Grove W10 5AD

Site Manager Stuart Lancaster
Facilities " Sean Bellamy

Fire alarm system

Addressable - C - Tac ZFP

Sounders

Detection mixed

Plans in fire box located at front entrance

Fire alarm tested by Workspace + records kept

EP & full evac

Fire drills - bi-annual - whole bldg

Unim Canal Deli FRA - 1/3/2016
Owner Stephanie Pena-Nur

Use + ^{max} number of persons present 64 $\frac{2}{3}$ 11 pages

Open 8- 4:30 p.m.

Bldg 5 floors
Premises 1

2,800 x

5

14,000

EP

- * Staff public to exit through front door
- alternative exit at rear - very small sign high up - not acceptable - as step
- Front exit partially blocked by display + down steps -

FRA sources of ignition included lots of info regarding H+S

- * SD in kitchen - not HD!

Oven cleaned daily

- * Boiler at back (for whole bldg) - FD
- closed

Tumble dryer - used only when staff present

- filter cleaned out weekly - stored in back room with FD

Fire alarm tested weekly

Fire Drill 15/10/2016

PAT → 14/2/2017

Means of fighting fire

* ~~Water duct in ceiling?~~ Sprinklers?

Fire mg scheduled for 16/1/2017 (include FFE)

Bldg opened 1/2/2016

* Section 6

2 members of staff at all times

7.2 ~~Young persons employed~~ - N/A?

9.2 Escape routes?

Checks + Maintenance EL? - ? Wkly.

13 Manager trained to use FFE 28/1/2016
- repeat mg?

Fire alarm maintained by workspace
PAT completed 14/2/2016 - due for
review 14/2/2017

C + C OK

FANS ✓

* Change in staff -

73

Union Canal Deli FRA - 1/3/2016
Owner Stephanie Pena-Nar

Use + ^{max} number of persons present 64 ~~3~~ ~~1/2~~

Open 8- 4:30 p.m.

Bldg 5 floors
Premises 1

2,800 x

5

14,000

EP

- Staff public to exit through front door
- alternative exit at rear - very small sign high up - not acceptable - as step
- Front exit partially blocked by display + down steps -

FRA sources of ignition includes lots of info regarding H+S

SD in kitchen - not HD!

Oven cleaned daily

Boiler at back (for whole bldg) - FD
- closed

Tumble dryer - used only when staff present
- filter cleaned out weekly - stored in back room with FD

Fire alarm tested weekly

Fire Drill 15/10/2016

PAT → 14/2/2017

Means of fighting fire

* ~~Water duct in ceiling?~~ ~~Sprinklers?~~

Fire img scheduled for 16/1/2017 (include FFE)

Bldg opened 1/2/2016

* Section 6

2 members of staff at all times

7.2 ~~Young persons employed - N/A?~~

9.2 Escape routes?

Checks + Maintenance EL? - ? Wkey.

13 Manager trained to use FFE 28/1/2016
- repeat img?

Fire alarm maintained by workspace
PAT completed 14/2/2016 - due for
review 14/2/2017

C + C OK

FEBS ✓

* Change in staff -

Timber cladding is it FR - ask
Wksp.

Workspace not having B&CP

Whole bldg space

6/1/2017 Friday

Chasheo 75-85 Old Brompton Rd
SW7 3LD Met with John Barrett
at 11:30 (Head of Security)

Blag
Basement, grd, + 5

Chasheo Occupy basement + ground

Incident 16/12/2016 - photo studio -
lamp bulb exploded - lots of smoke - duty
manager called brigade

Fully Addressable alarm system (3 panels)
EP is full evac regardless

Out of hrs = Red Care

EL ✓

SD ✓

Fire curtains throughout

Staff trained on induction with repeat

Internal maintenance team (fully qualified)

Maintain EL, 5 year fixed elects, SD,
fire doors. PAT external co.

Fire alarm maintained by external co.

Armoury - only 4 persons allowed in
metal doors

Security gate - residents have code
- staff will open if alarm

Fire Flat F

resident on strong medication
had fallen asleep whilst cooking

Occupants etc - own equipment
- iron, microwave, kettle, tvs, stereos
Keshia supply fridge/freezer cooker
w/m (no) tools) PAT
but not own

Community Forum 1x per month
- will include fire safety

Flats checked every day
Fire drill 1x per month
check ETE

321 Lillie Rd Weds 11/

Kesha Hg

Shaunna Glasgow Spl hsg wk

Laurette Darko " " "

3 staff on duty - sometimes lone.

12x offenders 13

2 self contained flats - 2 persons

office

3 gates - 3 shared flats - 3 tenants

2 self contained also single
people

24/7 staff
security

A+B above shops - 1 bldg

CDE purpose bit } 1 bldg.

F+G " " }

All post to office

FA interlinked between bldgs

Alarm set from box

All current residents can self
evac

Need to do fire drills weekly

Res - with mental health

EL - not checked -

No Special Needs residents
- can't accommodate

Front office FE blocked
door wedged - needs Dargnad

Plats CO₂ + fire blanket
- residents not trained

Starhan on bldg -

FFE Protec 28/12/2016

Evac all if fire
Blamed guests - signed in

~~All gas~~
All elec hobs

FFE in kits + in lobbies
SD in flats + H.D

Keys in flat F checked post
fire

Flat F disabled - not
wheelchair accessible

Residents are covering detector
heads ✓

Random checks needed
✓

Records

Protoc 27/1/2017

Mixed residents - all ages
Under 60 ✓

Gas safe - boilers
13/9/16

Evac drills

residents informed - some
don't respond / did respond
suggest random test

• Daily checks

MOE clear ✓

Fire Safety Trng

Induction trng

No full trng
✓

Sh 11 years - no full trng.
No online

Pictures used for learning disabled

Protoc - record ✓

Flat F ✓ S/C

Resident falls asleep with
candles on - can't Hestia
enforce - ✓

Mam che

SD in bedrooms

Our bld.
Stonham ~~Mag~~ Homes

staff know if member in

Meridian House

Arboret Street

Matthew Quinn?

FRA 2015, 25/6/

Aruley Rd,

FA BS5839-1 + 6

Leeds

Bennett Associates

LS12 2EW

EL

Hestia Mgr Support

Fire doors ✓ 8/8 ?

Maya SET 1LB

Mr Tuncail Hasan Service Mgr

PAT 2/2/2016

Service provider

Recommended upgrade of
FA system ✓ on upgrade

No Elec cert

FRA - recommended weekly
test of BGCP + recorded -
not being done
+ fire safety logs

C, D, E

Communal kitchen, lounge

FB, HD Kitchen

Door wedged - no EL,
no borrow

Corridor -

1x EL failed
1 wkg

Front door Flats C

long hole where lock
was fittedD all/OIC no EL
kitchen/lounge

2x EL - not wkg

A + B

Flats S/C

BGCP FANS

EL

10 yr battery interlocked

F/F outside Flat A -

not plugged in also

table + fan unit and last
week

FFE ✓ 6/16

EL on $\frac{1}{2}$ Indlg not wkg -
needs repair

F + G

BGCP FFE

EL ✓

FANS

Kitchen

Smoking in kitchen

No EL

FD ~~as~~ wedged + not
closing - S/C removed
- won't close
candles.

Living -

xmas lights - no PAT
smoking
over use of plug sockets
FD nr E/FIF

Front Door ✓ E

dbl latch - both
hands

Also DV ✓ dbl lock

No 'No Smoking Signs'
give 26 weeks

Stanhams Hsg Association Ltd
→ Home Group - Tyne + Wear
[REDACTED]

Stanhams:

EL ?

holes in doors

doors not closing

8/1

Staffing = 8
4 security

Basement bar

2 MOE

customers only b4 game - 1 hr

door from cellar not FD 3d

Pump room SD

need new FD

- old cylinders removed 2
weekly

Danien - since June

2nd final exit to open outwards

[REDACTED]

[REDACTED]

Tues 29/11/2016

Damien Smyth -

~~Owner of ah~~

Leased from

Enterprise

Accommodation above - access at
Side 121

~~2x cars parked outside~~

2nd Floor 6 rms

Rm 2 3 dbl bunk bunk
SD - door = FD SOS SS

Rm 1 Manager

Rm 5 3 dbl bunk - SD
Rm 6 2 dbl " no SD
4 3 " SD
3

needs Fire ext

Curtains are they FR
remove WLS

need FAN in inside door

EP = full evac

6 rooms

W8 6PW

W2 6NL \rightarrow W8 6PW = 40

W8 6PW \rightarrow W14 8AH = 30

W14 8AH \rightarrow W10 6HQ 35

W10 6HQ \rightarrow W2 6NL 20

Love of date