

Incoming Email
from

Bruce Sounes
<bruce@studioe.co.uk>

on
30/10/2013 16:38

Create Mail Reply

File Ref 1 Architect

File Ref 2 None

File Ref 3 None

To: "d.campbell@maxfordham.com" <d.campbell@maxfordham.com>

cc: "M.Smith@maxfordham.com" <M.Smith@maxfordham.com>; Terry Ashton
<Terry.Ashton@Exova.com>; Grenfell <Grenfell@studioe.co.uk>

Subject: Grenfell - Smoke exhaust LFB submission.

Associated Documents

created by: **Bruce Sounes** on 30-Oct-13

Duncan,

I have spoken to Matt but in brief these are the points Paul Hanson discussed with me earlier today when he called:

- He suggests forwarding your report directly to the London Fire Brigade.
- He is going to hold on doing so because he thinks it needs more clarity:
- “..is designed .. as a natural ventilation system...” (line 2) is followed by “a mechanical supply and extract system which does not rely on natural ventilation” (Smoke Control, second para). His initial response is that this reads like we are omitting a compliant natural vent shaft.
- I didn’t send your schematic but he thinks some diagrams would be useful. We can contribute, eg:

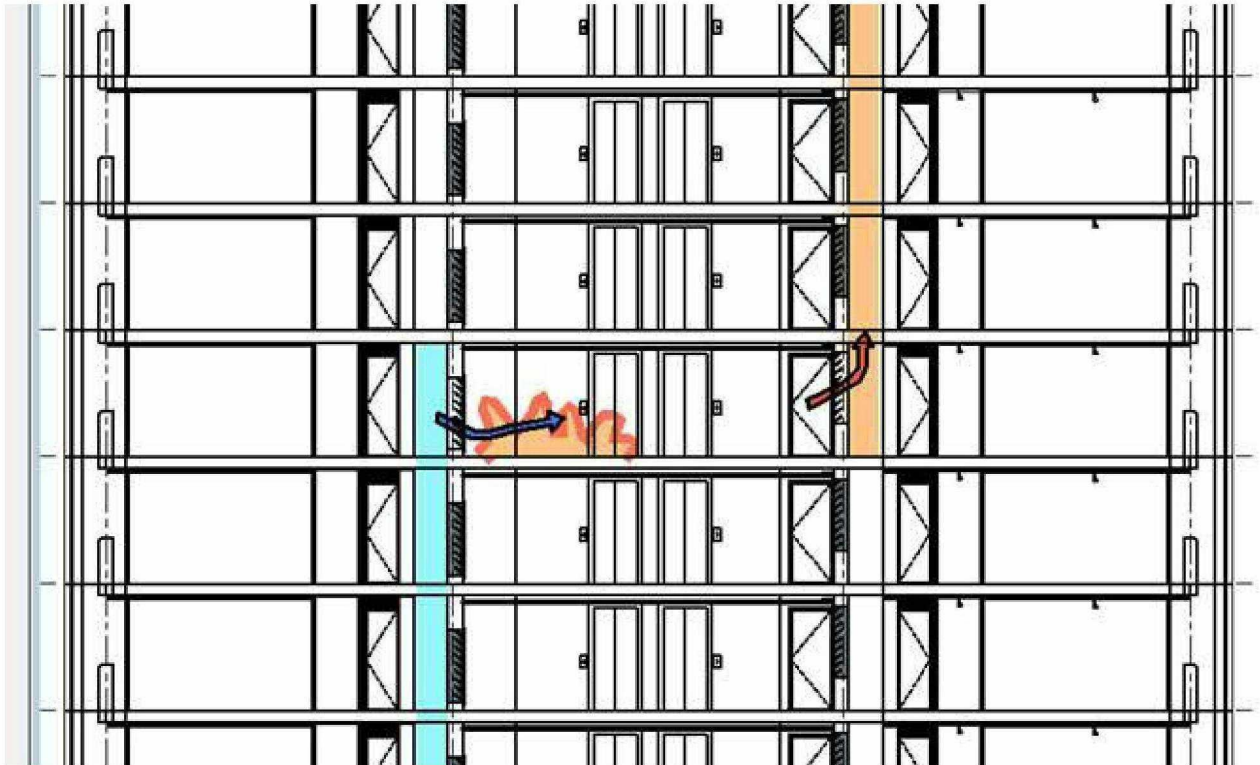

- Principle of dual use of duct for vent and smoke okay – but not clear from document and would like some detail as to how this will be achieved.
- Describe sequencing of dampers shutting on alarm.
- Query rates of flow – m^3/s & air changes.
- Query how you balance the system with powered supply as opposed to powered extract only.

Paul Hanson



Paul.Hanson@rbkc.gov.uk

Regards

Bruce Sounes

For and on behalf of

STUDIO E LLP

Palace Wharf, Rainville Road, London W6 9HN

T [REDACTED] | **F** [REDACTED] | www.studioe.co.uk