

Message

From: Bruce Sounes [/O=STUDIO E/OU=FIRST ADMINISTRATIVE GROUP/CN=RECIPIENTS/CN=BRUCE]
Sent: 10/08/2012 10:51:08
To: Cate Cooney [Cate.Cooney@Exova.com]
CC: Paul Dunkerton [pdunkerton@kctmo.org.uk]; Grenfell [Grenfell@studioe.co.uk]; A.McQuatt@maxfordham.com; M.Smith@maxfordham.com
Subject: RE: Grenfell Tower
Attachments: IMG00011-20120306-1651.jpg; IMG00012-20120306-1651.jpg; IMG00048-20120411-1028.jpg; IMG00015-20120306-1654.jpg; IMG_6022.JPG; IMG_5870.JPG

Dear Cate,

Yesterday was the project meeting for Grenfell. I will answer your questions as best I can. Paul Dunkerton might be able to forward to the right person in the TMO if you need further clarification:

The stair is not pressurized. See attached images:

IMG00048 – Louvre opening to the outside at the first landing of the stair at Deck level.

IMG00015 – Vent to top of stair and ladder access to roof/lift .

IMG6022 – image of same at roof level.

IMG00011 – Inlet vent to lobby, repeated at each residential level. Extract at high level on opposite wall through similar grille.

Dry riser - yes

IMG00012 – Dry riser at residential floor level. Ground floor location as below.

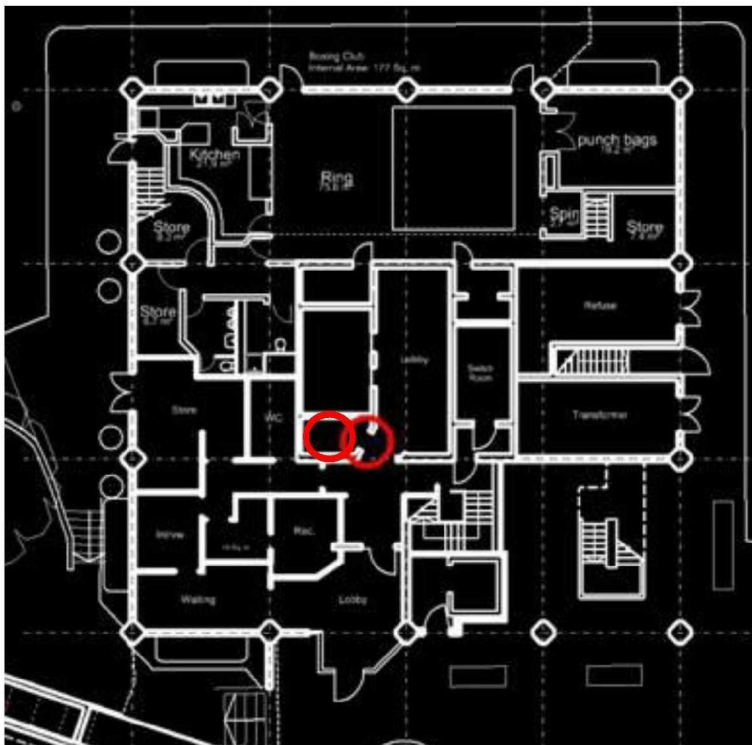

Fire fighting lift – no

Fire rating – not sure but the lifts were refurbished a few years ago. Paul, might you be able to clarify?

IMG 5870 – Existing lift doors.

Regards

Bruce Sounes

For and on behalf of
STUDIO E LLP

Palace Wharf, Rainville Road, London W6 9HN

T [REDACTED] | F [REDACTED] | www.studioe.co.uk



Queen's Award for Enterprise: Sustainable Development 2010

BCSE Award School Architect of the Year 2008 & 2010

BCSE Award Inspiring Design Primary School 2008 & Academy 2010

BSF Award Excellence in Student Engagement 2009

Sustainable City Award 2009



Please consider the environment before printing this email.

ELECTRONIC INFORMATION TRANSFER DISCLAIMER

This email and any files transmitted with it are sent for and on behalf of Studio E and are intended solely for the use of the individual or entity to whom they are addressed. If you have received this email in error please notify the sender. All attached files are copyright and may only be used for the purpose stated in the drawing status box. In the event that the files are altered in anyway, it is a condition of use that the Studio E name and logo be removed from the modified file, unless prior written agreement has been obtained. Studio E will assume no responsibility for the accuracy, adequacy, and integrity of the files, and recommends that the files be thoroughly screened for viruses prior to installation. Opinions, conclusions and other information expressed in this message are not given or endorsed by Studio E LLP unless otherwise indicated by an authorised representative independent of this message.

From: Cate Cooney [mailto:Cate.Cooney@Exova.com]

Sent: 09 August 2012 16:12

To: Bruce Sounes

Subject: Grenfell Tower

Hello Bruce,

I tried to contact you earlier, but you were on site. I am working with Clare Barker on the existing fire strategy for Grenfell Tower and have a couple of questions I hope you can answer for me?

Is the single stair serving the residential levels pressurized or is it only the lobbies to the flats which have ventilation provision?

Is there a dry riser?

Is there a fire fighting lift?

Do you know the construction of the riser doors ie whether they provide 2 hours fire resistance?

With an existing building I appreciate some information does vapourise over time. Any information you can provide would be useful.

Many thanks

Cate

SEA00005651_0002

SEA00005651/2

Cate Cooney: Senior Consultant, Fire Engineering (Europe)

T: [REDACTED] M: +[REDACTED]

Exova Warrington Fire



This transmission may contain information that is privileged, confidential and /or exempt from disclosure under applicable Law.

If you are not the intended recipient, you are hereby notified that any disclosure, copying, distribution, or use of the information contained herein is **STRICTLY PROHIBITED**. If you receive this transmission in error, please immediately contact the sender and destroy the material in its entirety, whether in electronic or hard copy format.

Exova is the trading name of Exova Group Limited, Exova Group BV and all subsidiaries therein.

Exova Group Ltd. Registered office: 6 Coronet Way, Centenary Park, Salford, Manchester M50 1RE.
Registered in the United Kingdom, Company Number 06720350.

Exova Warringtonfire Aus Pty Ltd Registered office: Unit 2, 409-411 Hammond Road, Dandenong, VIC 3175, Australia, ABN 81 050 241 524.

Exova Group BV is registered in The Netherlands.

Please consider the environment before printing this e-mail and any associated attachments.
